



 NetballSmart

NETBALL NZ
OPEN CHAMPS



5-9 September 2023

Edgar Centre,
Dunedin

We live this game.



NETBALL
NEW ZEALAND
POITARAWHITI AOTEAROA

With Thanks to Our Partners



	<u>Page</u>
Netball New Zealand Message	2
Netball South Message	3
Championship Officials	4
Technical Officials	5
Award History	6
Previous Winners	7
Medical Services	11
Court Layout	12
Event Schedule	13
Teams	14
Draw	15
Draw Notes	20
Results	22
Final Placings	30
Team Lists	31
Rules	36
Code of Conduct	41
Notes	42
Follow the Event	44

Tuia te rangi e tū nei
Tuia te papa e takoto nei
Tuia te herenga tangata
Kia puta ki te wheiao, ki te ao mārama!

Ngāi Tahu, te mana ki Te Waipounamu, ki a koutou ngā mihi nui. Tēnā koutou katoa e manaaki nei i tēnei kaupapa e whakatairanga ana i te kairangi o te poi tarawhiti i ngā motu e rua o Aotearoa.

E ngā kaitākaro, e ngā kaiwawao, e ngā kaiako, e ngā kaimahi, e ngā kaitautoko, e ngā kaiwhakahaere tēnā koutou i tā tātou whakataetae e huihui nei tātou. Kia kaha, kia māia, kia toa!

Nau mai - welcome to the Edgar Centre in Ōtepoti - Dunedin for the 2023 NetballSmart Netball NZ Open Champs. The term back to the future resonates as I return to Dunedin albeit wearing another hat. I recall the considerable influence Dunedin has had on netball as they hosted the first National Provincial Championship tournament indoors in 1990. Twenty-two umpires were appointed to the tournament, and I was privileged to be one of them. This event became the template for the indoor netball facility deliberations.

Like most national events, the success is hugely reliant on the generosity of others. Netball events are no different. Volunteers, sponsors the teams behind the team – the coaches, managers, support staff, umpires, statisticians, and bench officials, not forgetting spectators and whānau support are imperative and provide a significant contribution to the game. Added to this mix are the valuable leadership qualities highlighted at regional and centre levels who transform cities and towns into national Netball HUBs leaving no stone unturned in preparations, so the event runs smoothly, efficiently, and is fit for purpose.

It is on that note that Netball New Zealand wishes to acknowledge the Netball South team for hosting the 2023 NetballSmart Netball NZ Open Champs and is grateful and appreciative of the energy and effort put into this important annual netball event by them all. The four days of quality Netball put on display will illuminate the best Open teams from Centres from around the country. It is also a platform in which to raise the profile of this beautiful city and to share its unique features with manuhiri - visitors.

In closing, domestic events such as the Open are a crucial step on the high-performance netball pathway. It is where future representatives are identified and their dreams to transition to other competitions such as the Synergy Hair Netball League, ANZ Premiership and onto the pinnacle stage and into the black dress – Silver Ferns honours are realised. With that, on behalf of NNZ and our team we wish everyone a successful event.

Ngā mihi aroha

Tina Karaitiana
President
Netball New Zealand

Kia ora koutou,

Welcome to Dunedin. It is fantastic to have you all here for the NetballSmart Netball NZ Open Champs.

This event brings together the best Open Women players throughout the country to participate in what will be a significant and notable netball national event, showcasing a mixture of experienced players and up-and-coming talent across many of the teams.

To Netball New Zealand, zones, the netball centres, coaches, managers, support staff, boards, players, supporters and our volunteers, thank you for all you do so our game can be enjoyed. We are excited to get underway with the action on court.

While in Dunedin, you will discover an amazing array of cafes, bars and restaurants to keep yourself well-nourished during your stay. Dunedin prides itself on its beautiful heritage, stunning scenery and plenty of old-fashioned southern hospitality. Get out and explore all this city has to offer.

Our Netball South team are extremely enthusiastic about supporting Netball New Zealand and Netball Smart in the delivery of this Open Champs National event to you all. We're expecting a captivating level of netball given the strong teams featuring throughout this tournament. We are all in for a treat!

Kia kaha

Sonya Fleming
Chief Executive
Netball South

NETBALL NZ REPRESENTATIVES

Emma Fowlie	Head of Events and Competitions
Dan Robinson	Event Manager
Brenna Ward	Event Administrator
Tina Karaitiana	President
Garratt Williamson	National Technical Officials Manager
Nicky Cattermoul	Pathway Programs Manager
John Whiting	Digital and Content Manager
Maddy van Wichen	Graphic Designer

CHAMPIONSHIP COMMITTEE

Emma Fowlie
Dan Robinson
Garratt Williamson

NZ U21 COACHES

Te Aroha Keenan
Julie Seymour

NETBALL NZ SELECTORS

Robin Manihera
Adrienne Morrin

UMPIRE PANEL

Garratt Williamson - Convenor
Pam Clayton
Kirsten Lloyd
David Pala'amo
Jan Teesdale

UMPIRES

Hayes Andrew
Caleb Binns
Morgan Craig
Myron Elkington
Te Kaweora Enoka-Barton
Tania Fink
Jane Hickmott
Marlissa Howard
Lockie McLaren
Shannon Michelle
Zak Middleton
Liam Minhinnick
Kira Morrison
Connor Pascoe
Rebecca Reside
Alannah Robinson
Jamie Smith
Hayley Taylor
Amelia Wheeler

STATISTICIANS

Sam Kerins - Coordinator
Lisa Aull
Sharon French
Victoria Howden
Raylene Leith-Forbes
Carolyn Leonard
Rachael Smith

BENCH OFFICIALS

Julie Erskine - Coordinator
Nicky Baggott
Gail Benseman
Louise Bridgeman
Bobby-Jo Buchanan
Violet Cook
Nikki Gray
Irene Leonard
Sarah Love
Lillian Martin
Annitta Michelle
Josiena Mourits
Aileen Neilson
Janice Paterson
Sharron Ridd
Jean Rowley
Karen Sinclair
Emma Smith
Christine Thomlinson
Christine Thompson
Alison Tranter
Kenzie Turnbull
Lyn Wilson

NEW ZEALAND CUP

Winner

First presented in 1926 by an anonymous donor, later established as Mrs R. S. McInnes, first President of the New Zealand Basketball Association, for winners of the NZ Tournament. When the tournament is divided into grades, the New Zealand Cup is competed for by First Grade teams.

ANNIE BROWN CUP

Runner-up

In 1929 it was donated by Mrs W. Brown, then President of Canterbury Association, for runners-up at NZ Tournament. It is now the trophy for runners-up in the First Grade. Mrs Brown was active in basketball/netball for many years and was affectionately known as 'Auntie' Brown throughout the country.

LADY JUNE BLUNDELL SILVER SALVER

For highest number of goals scored

In 1977 it was presented to N.Z.N.A by Lady June Blundell on her retirement as Patroness to be awarded to the team with the highest number of goals scored.

VIOLET GILMOUR TROPHY

For lowest goals scored against

In 1948 a rosebowl was presented by the Mayor of New Plymouth, Mr E. Gilmour, in the name of his wife, to be awarded to the team, irrespective of grade, with the lowest average of goals scored against during a NZ Tournament.

GISBORNE CUP

For standard of playing uniform

In 1956 the Mayor of Gisborne, Mr H. H. Barker, was so impressed with the appearance of the teams in the Street Parade held prior to Tournament in Gisborne that he asked permission to donate a trophy. This cup is awarded for neatness and uniformity of team uniforms and general demeanour.

	New Zealand Cup	Annie Brown Cup	Lady June Blundell Silver Salver	Violet Gilmour Trophy	Gisborne Cup
2022	North Harbour	Hamilton City	North Harbour	Tauranga	Eastern Waikato
2015	Wellington	North Harbour	Wellington	Wellington	Waikato
2014	Christchurch	North Harbour	Christchurch	Hutt Valley	Waikato
2013	Otago A	Hamilton	Otago	Wellington	Auckland
2012	Otago	Trust Waikato	Waikato	Western	Counties Manukau
2011	Canterbury	Otago	Western	Waikato	Western
2010	Mainland Foundation Canterbury	Auckland Waikato 1	Canterbury	Counties Manukau	Canterbury
2009	Auckland Waikato	Asot Park Hotel Southland	Wellington	Wellington	Otago
2008	Southland	Auckland Waikato	Canterbury	Western	Netball North
2007	Auckland Waikato	North	Netball North	Auckland Waikato	Bay of Plenty
2006	Waikato	Auckland Waikato	Southland	Waikato	Bay of Plenty
2005	North	Trust Waikato	Waikato	Otago	Western
2004	Trust Waikato	North	Waikato	Canterbury B	Waikato
2003	Waikato	Netball North	Netball North	Auckland Waikato	Eastern
2002	Canterbury	Otago	Waikato	Waikato Premier	Eastern
2001	Canterbury	Waikato	Taranaki	Southland B	Netball North
2000	Trust Waikato	Canterbury	Taranaki	Eastern	Canterbury
1999	Waikato	ASB Auckland	Canterbury	Canterbury	Eastern
1998	Otago	Wellington	Manakau	Canterbury	Marlborough
1997	ASB North Harbour	Otago Gold	Manawatu	Wellington	Southland
1996	Wellington	Otago	Southland	Wellington	Manawatu
1995	Auckland	Canterbury	Auckland Union	Aoraki	Manukau
1994	Auckland	Wellington	Auckland Union	Northland	Otago
1993	Auckland	Otago	West Auckland	West Auckland	Canterbury Country
1992	Auckland	Wellington	Auckland Union	Sunrise Coast	Buller Westland

New Zealand Cup	Annie Brown Cup	Lady June Blundell Silver Salver	Violet Gilmour Trophy	Gisborne Cup
1991	Auckland	Canterbury	West Auckland	North Harbour
1990	Auckland	North Harbour	West Auckland	Mid Canterbury
1989	Auckland	Wellington	Riverlands	Manukau
1988	Auckland	Waikato	Manawatu Subs	Hutt Valley
1987	Auckland	North Shore	North Shore Subs	Waioa
1986	Auckland	North Shore	Te Kowau	Manawatu
1985	Wellington	Auckland, Canterbury and Waikato	Lower Hutt	West Auckland
1984	Canterbury, Waikato and Wellington	Auckland	Counties	Horowhenua
1983	Waikato	Auckland	Wairapa	Hawkes Bay
1982	Canterbury and Waikato	North Shore and Auckland	Poverty Bay	Howick Pakuranga
1981	Canterbury	Waikato	Ashburton	North Shore
1980	Canterbury	Auckland	Wellington Minor	Northland
1979	Canterbury	Auckland	Hawke's Bay Minor	Thames Valley
1978	Auckland and Canterbury	Wellington	Howick Districts	North Shore
1977	Auckland	Waikato and Wellington	Te Kowau	
1976	Canterbury and Wellington	North Shore and Auckland	West Coast	Southland
1975	Auckland	Canterbury and Wellington	Western Districts	South Auckland
1974	Waikato and Wellington	Canterbury	Western Districts	Poverty Bay
1973	Auckland	Canterbury	Waikato	Poverty Bay
1972	Wellington	South Canterbury	Otago Country	Manawatu
1971	Canterbury	Rotorua	Wellington Minor	Auckland
1970	Canterbury	Rotorua, Wellington and South Canterbury	South Waikato	Wairapa
1969	Canterbury	South Canterbury	King County	Auckland

	New Zealand Cup	Annie Brown Cup	Lady June Blundell Silver Salver	Violet Gilmour Trophy	Gisborne Cup
1968	Canterbury	Wellington		Taranaki	Te Kowau
1967	Auckland and Rotorua	Southland and Wellington		South Canterbury	Western Bay of Plenty
1966	Rotorua	Canterbury and Southland		Eastern Bay of Plenty	South Auckland
1965	Rotorua	Southland		Marlborough	Poverty Bay
1964	Rotorua	Southland			
1963	Canterbury	Southland		North Otago	Poverty Bay
1962	Rotorua and Canterbury	Matamata		Central King Country	Southland Country
1961	Otago and Canterbury	Wellington and Auckland		Otago	Hokitika
1960	Canterbury	Auckland		North Otago	South Canterbury
1959	Southland	Canterbury		Wairarapa	West Coast
1958	Southland	Canterbury		North Otago	Hokitika
1957	Auckland	Southland		Otago	Hutt Valley
1956	Canterbury	Hawke's Bay		Te Kowau	Hawke's Bay
1955	Canterbury	Auckland		Northland	
1954	Canterbury	Auckland and Hawke's Bay		Otago Minor	
1953	Auckland	Canterbury		Canterbury Minor	
1952	Canterbury	Auckland		Canterbury	
1951	Canterbury	Auckland		Canterbury	
1950	Canterbury	Auckland and Tauranga		Canterbury	
1949	Auckland	Canterbury		Tauranga	
1948	Canterbury	Auckland		Tauranga	
1947	Canterbury	Auckland			
1946	Manawatu and Auckland	Canterbury			
1945	Canterbury	Otago			
1944	No tournament				
1943	No tournament				

New Zealand Cup

Annie Brown Cup

Lady June Blundell
Silver Salver

Violet Gilmour
Trophy

Gisborne Cup

1942	No tournament				
1941	Hawke's Bay	Auckland			
1940	Auckland	Wellington			
1939	Auckland and Wellington	Southland			
1938	Wellington and Canterbury	Southland			
1937	Wellington	Auckland			
1936	Southland	Auckland			
1935	Wellington	Otago			
1934	Wellington	Canterbury			
1933	Auckland	Wellington			
1932	Otago	Wellington			
1931	Auckland (by challenge)	Wellington			
1930	Auckland	Wellington			
1929	Auckland	Wellington			
1928	Auckland				
1927	Auckland				
1926	Auckland				

Medical Centres

Dunedin Urgent Doctors and Accident Centre

Walk-in clinic open seven days from 8am to 10pm

18 Filleul Street, Dunedin, 9016

Phone: 03 479 2900

Dunedin Hospital

Open 24 hours / 7 days

201 Great King Street, Central Dunedin, Dunedin

Open 24 hours

Phone: 03 474 0999

Dentist

Synergy Dental

EMERGENCY DENTAL CARE

Open till 8pm Mon-Thu and 4.30pm Fri-Sat.

Level 7, John Wickliffe House

265 Princes Street

Central Dunedin

03 477 1477

Pharmacy

Bayview Pharmacy

Located in: The Warehouse South Dunedin

64 Hillside Road, South Dunedin, Dunedin 9012

Open till 7pm weekdays and 5.30pm weekends

Phone: 03 455 4743

Physio

Roslyn Physio

287 Highgate, Roslyn, Dunedin 9010

03 4771744

Healthline

Phone 0800 611 116

Free healthcare advice from trained registered nurses

Available 24 hours a day, 7 days a week

They can also tell you where to find your nearest GP after-hours service, hospital emergency department, pharmacy or out-of-hours dental surgery.

Elite Medical

Elite Medical will be on-site throughout the week for any medical emergencies or issues throughout the tournament. Karl and the team can be contacted on 0800 4367 111.

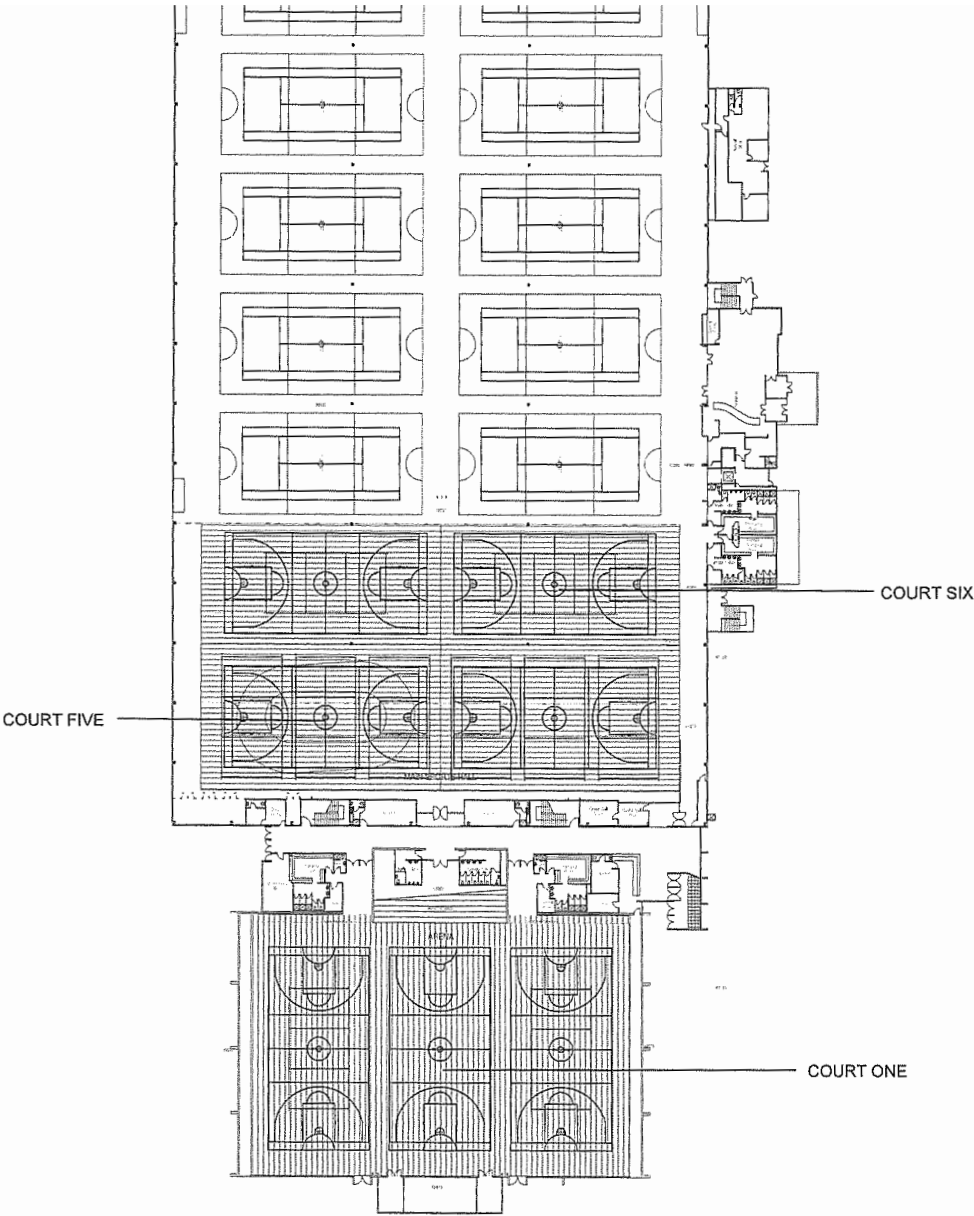

TUESDAY 5 SEPTEMBER

10am

Championship pool play commences

WEDNESDAY 6 SEPTEMBER

10am

Championship pool play

THURSDAY 7 SEPTEMBER

8.30am

Championship pool play ends

Championship post pool play commences

FRIDAY 8 SEPTEMBER

10am

Championship post pool play continues

SATURDAY 9 SEPTEMBER

8.30am

Final play-off matches

1.30 pm

Open Champs Grand Final

Post-final presentation

GAME INFORMATION

Duration of games – 48 mins

These are played in 4 x 12min quarters, with intervals of 4 minutes between the first and second and third and fourth quarters and an interval of 6 minutes for half time.

4 points	Win
2 points	Draw
1 point	Loss (3 goals or less)
0 points	Loss (more than 3 goals)

POOL A

TEAM

North Harbour
Invercargill
Waitakere
Hutt Valley

ZONE

Northern
South
Northern
Central

POOL B

TEAM

Hamilton City
Auckland
Cambridge
Dunedin
Central Lakes

ZONE

Waikato Bay of Plenty
Northern
Waikato Bay of Plenty
South
South

POOL C

TEAM

Tauranga
Manawatu
Wellington
Rotorua
Christchurch Black

ZONE

Waikato Bay of Plenty
Central
Central
Waikato Bay of Plenty
Mainland

POOL D

TEAM

Counties Manukau Cluster
Christchurch Red
Taranaki
Gisborne
Howick Pakuranga

ZONE

Northern
Mainland
Central
Waikato Bay of Plenty
Northern

Tuesday 5th September - Draws Permitted

Court	Game	Pool	Team 1	Team 2			
10am							
BYES DURING MORNING: GROUP A, B1 HAMILTON CITY, C3 WELLINGTON, D2 CHRISTCHURCH RED							
1	1	D	Taranaki		v		Howick Pakuranga
5	2	D	Counties Manukau Cluster		v		Gisborne
6	3	C	Manawatu		v		Rotorua
11.30am							
1	4	B	Cambridge		v		Central Lakes
5	5	B	Auckland		v		Dunedin
6	6	C	Christchurch Black		v		Tauranga
1.00pm							
2.30pm							
BYES DURING AFTERNOON: B2 AUCKLAND, C2 MANAWATU, D3 TARANAKI							
1	7	A	North Harbour		v		Hutt Valley
5	8	A	Invercargill		v		Waitakere
4pm							
1	9	D	Christchurch Red		v		Gisborne
5	10	B	Hamilton City		v		Cambridge
6	11	B	Dunedin		v		Central Lakes
5.30pm							
1	12	D	Counties Manukau Cluster		v		Howick Pakuranga
5	13	C	Wellington		v		Christchurch Black
6	14	C	Tauranga		v		Rotorua

Wednesday 6th September - Draws Permitted

Court	Game	Pool	Team 1				Team 2
10am BYES DURING MORNING: GROUP A, B3 CAMBRIDGE, C1 TAURANGA, D4 GISBORNE							
1	15	D	Christchurch Red		v		Howick Pakuranga
5	16	B	Central Lakes		v		Auckland
6	17	B	Hamilton City		v		Dunedin
11.30am							
1	18	D	Counties Manukau Cluster		v		Taranaki
5	19	C	Wellington		v		Manawatu
6	20	C	Rotorua		v		Christchurch Black
1pm							
2.30pm BYES DURING AFTERNOON: B4 DUNEDIN, C4 ROTORUA, D1 COUNTIES MANUKAU CLUSTER							
1	21	A	Waitakere		v		Hutt Valley
5	22	A	Invercargill		v		North Harbour
4pm							
1	23	B	Cambridge		v		Auckland
5	24	B	Hamilton City		v		Central Lakes
6	25	D	Gisborne		v		Howick Pakuranga
5.30pm							
1	26	D	Christchurch Red		v		Taranaki
5	27	C	Tauranga		v		Wellington
6	28	C	Christchurch Black		v		Manawatu

Thursday 7th September - Games with # must play to a result

Court			Game			Pool			Team 1				Team 2														
8.30am														BYES DURING MORNING: B5 CENTRAL LAKES, C5 CHRISTCHURCH BLACK, D5 HOWICK PAKURANGA													
1		29		C				Wellington						v						Rotorua							
5		30		A				Waitakere						v						North Harbour							
10am																											
1		31		C				Tauranga						v						Manawatu							
5		32		B				Hamilton City						v						Auckland							
6		33		D				Taranaki						v						Gisborne							
11.30am																											
1		34		B				Cambridge						v						Dunedin							
5		35		A				Hutt Valley						v						Invercargill							
6		36		D				Counties Manukau Cluster						v						Christchurch Red							
1pm																											
2.30pm																											
4pm																											
BYES DURING AFTERNOON: TOP EIGHT (A1/A2/B1/B2/C1/C2/D1/D2)																											
1		37		9 to 16 #		B3								v				C4									
5		38		9 to 16 #		A3								v				D4									
6		39		17 to 20		B5								v				C5									
5.30pm																											
1		40		9 to 16 #		C3								v				B4									
5		41		9 to 16 #		D3								v				A4									
6		42		17 to 20		D5								v				Q1									

Friday 8th September - Games with # must play to a result

Court			Game		Pool		Team 1				Team 2			
8.30am														
10am														
1	43	1 to 8 #	C1				v		B2					
5	44	1 to 8 #	A1				v		D2					
11.30am														
1	45	1 to 8 #	B1				v		C2					
5	46	1 to 8 #	D1				v		A2					
6	47	17 to 20	D5				v		B5					
1pm														
1	48	9 to 12 #	W37				v		W41					
5	49	13 to 16 #	L37				v		L41					
2.30pm														
1	50	9 to 12 #	W38				v		W40					
5	51	13 to 16 #	L38				v		L40					
4pm														
1	52	1 to 4 #	W43				v		W44					
5	53	5 to 8 #	L43				v		L44					
5.30pm														
1	54	1 to 4 #	W45				v		W46					
5	55	5 to 8 #	L45				v		L46					
6	56	17 to 20	C5				v		Q1					

Saturday 9th September - Games with # must play to a result

Court	Game	Pool	Team 1				Team 2			
8.30am										
1	57	15th/16th #	L49			v		L51		
5	58	17 to 20	Q1			v		B5		
6	59	17 to 20	C5			v		D5		
10am										
1	60	7th/8th #	L53			v		L55		
5	61	9th/10th #	W48			v		W50		
6	62	13th/14th #	W49			v		W51		
11.30am										
1	63	3rd/4th #	L52			v		L54		
5	64	5th/6th #	W53			v		W55		
6	65	11th/12th #	L48			v		L50		
1pm										
1	66	1st/2nd #	W52			v		W54		

NetballSmart Netball New Zealand Open Champs format for 2023:

1. Nineteen (19) teams entered
2. Initial section seeding based on 2022 Open Champs results with the note that;
 - a. Where there are two teams from one Centre, or more than two teams from one Zone the seeding has been managed with some teams seeding's altered with other teams.
 - b. Seeding movement is limited to no more than three positions.
 - c. Teams that did not compete in 2022 are seeded at the bottom of each section.
 - d. Where teams have not entered in 2023 all teams are moved up in seeding and then re-ranked.
3. Initial pools – 3 pools of 5, 1 pool of 4 - Pools A, B, C, D.
4. Phase one – round robin – (3 or 4 games):
 - a. All teams play each other in their pool. Draws are permitted.
 - b. Tuesday, Wednesday, Thursday (morning only) - All teams play 1 or 2 games each day in round robin
 - c. At end of Phase one round robin, all teams are re-ranked based on position within their pool that is A1, A2, A3, A4, A5 etc.
5. Phase two - Post-Section play – all teams are allocated into three groups – games that must play to a result will be indicated on the draw:
 - a. Top two teams from each section move into the TOP 8 – playing for 1st to 8th.
 - b. Third and fourth placed team in each section move into the MIDDLE 8 – playing for 9th to 16th.
 - c. Fifth placed teams in each section move to the BOTTOM 3 – playing for 17th – 19th.

TOP 8 – 1st to 8th (3 games)

A1/A2/B1/B2/C1/C2/D1/D2

- Friday am – Quarter-finals
- Friday pm – Semi-finals
- Saturday – Final Play-offs

MIDDLE 8 – 9th to 16th (3 games)

A3/A4/B3/B4/C3/C4/D3/D4

- Thursday pm – Quarter-finals
- Friday – Semi-finals
- Saturday – Final Play-offs

BOTTOM 3 – 17th to 19th (3 games)

all games in this section may end in a draw

Q1/B5/C5/D5

Round robin - pool placings decided on points

Thursday pm / Friday / Saturday

Q1 will be a development side from Dunedin - they will not earn points in the competition, so won't place, but will play B5, C5 & D5 so they have an equal amount of games during the tournament

6. Teams will play a total of 6 or 7 games
7. Teams will have a minimum of two rounds off between games
8. All teams will have a minimum of 1 game per day unless B5 (Central Lakes), C5 (Christchurch Black) or D5 (Howick Pakuranga) place in the top 2 of their pool. If this happens they will not play any games on Thursday

GAMES THAT MUST RESULT IN AN OUTRIGHT WINNER (I.E. CANNOT END IN A DRAW) ARE IDENTIFIED ON THE DRAW AND WILL BE NOTIFIED IN ADVANCE TO TEAMS DURING THE EVENT

2023 NETBALLSMART NETBALL NZ OPEN CHAMPS - POOL A								
POOL A	North Harbour	Invercargill	Waitakere	Hutt Valley	GOALS FOR	TOTAL POINTS	GOAL AVERAGE	POOL PLACING
North Harbour								
Invercargill								
Waitakere								
Hutt Valley								
GOALS AGAINST								

2023 NETBALLSMART NETBALL NZ OPEN CHAMPS - POOL B									
POOL B	Hamilton City	Auckland	Cambridge	Dunedin	Central Lakes	GOALS FOR	TOTAL POINTS	GOAL AVERAGE	POOL PLACING
Hamilton City									
Auckland									
Cambridge									
Dunedin									
Central Lakes									
GOALS AGAINST									

2023 NETBALLSMART NETBALL NZ OPEN CHAMPS - POOL C									
POOL C	Tauranga	Manawatu	Wellington	Rotorua	Christchurch Black	GOALS FOR	TOTAL POINTS	GOAL AVERAGE	POOL PLACING
Tauranga									
Manawatu									
Wellington									
Rotorua									
Christchurch Black									
GOALS AGAINST									

2023 NETBALLSMART NETBALL NZ OPEN CHAMPS - POOL D									
POOL D	Counties Manukau Cluster	Christchurch Red	Taranaki	Gisborne	Howick Pakuranga	GOALS FOR	TOTAL POINTS	GOAL AVERAGE	POOL PLACING
Counties Manukau Cluster									
Christchurch Red									
Taranaki									
Gisborne									
Howick Pakuranga									
GOALS AGAINST									

RESULTS

1 - 8

A1 _____

A2 _____

B1 _____

B2 _____

C1 _____

C2 _____

D1 _____

D2 _____

9 - 16

A3 _____

A4 _____

B3 _____

B4 _____

C3 _____

C4 _____

D3 _____

D4 _____

17 - 20

Q1 _____

B5 _____

C5 _____

D5 _____

1 - 8 QUARTER FINALS

Game 43

C1 _____ B2 _____

Game 44

A1 _____ D2 _____

Game 45

B1 _____ C2 _____

Game 46

D1 _____ A2 _____

1 - 4 SEMI - FINALS

Game 52

W43 _____ W44 _____

Game 54

W45 _____ W46 _____

5 - 8 SEMI - FINALS

Game 53

L43 _____ L44 _____

Game 55

L45 _____ L46 _____

1 - 8 FINAL PLAYOFFS

7th/8th

L53 _____ L55 _____

5th/6th

W53 _____ W55 _____

3th/4th

L52 _____ L54 _____

1st/2nd

W52 _____ W54 _____

9 - 16 QUARTER FINALS

Game 37

B3 _____ C4 _____

Game 38

A3 _____ D4 _____

Game 40

C3 _____ B4 _____

Game 41

D3 _____ A4 _____

9 - 12 SEMI - FINALS

Game 48

W37 _____ W41 _____

Game 50

W38 _____ W40 _____

13 - 16 SEMI - FINALS

Game 49

L37 _____ L41 _____

Game 51

L38 _____ L40 _____

9 - 16 FINAL PLAYOFFS

15th/16th

L49 _____ L51 _____

13th/14th

W49 _____ W51 _____

11th/12th

L48 _____ L50 _____

9th/10th

W48 _____ W50 _____

2023 NetballSmart Netball NZ Open Champs - 17th - 20th								
17th - 20th	Q1 - Dunedin Development				GOALS FOR	TOTAL POINTS	GOAL AVERAGE	FINAL PLACING
Q1 - Dunedin Development								
GOALS AGAINST								

17th - 20th

Game 39

B5

C5

Game 42

D5

Q1

Game 47

D5

B5

Game 56

C5

Q1

Game 58

Q1

B5

Game 59

C5

D5

FINAL PLACINGS

1st

2nd

3rd

4th

5th

6th

7th

8th

9th

10th

11th

12th

13th

14th

15th

16th

17th

18th

19th

AUCKLAND

Leila Atkins
Storm Gilmer
Catherine Hall
Jamie Hume
Lavina Lavea
Charlotte Manley
Crystal Maro
Holly Mather
Brooklyn Murray
Samon Nathan
Kenza Tæle

Captain: Samon Nathan
Coach: Natalie Milicich
Assistant Coach: April Ieremia
Manager: Debra Charteris
Primary Care: Alannah Meikle
Apprentice Coach: Rachel Rassmussen

CENTRAL LAKES

Hannah Bisset
Andrea Cotton
Chloe Davis
Abbey Erwood
Georgia Greig
Isla Henderson
Ellie McKone
Charlotte Mossman
Holly Munro
Stevie Paine
Hannah Symon

Captain: Abby Erwood
Coach: Janine Laney
Primary Care: Jenny Ferguson

CAMBRIDGE

Georgia Bodle
Tegan Broomfield
Mikayla Gillespie
Grace McCarthy
Demi Moana
Anahia Noble
Keeley Portegys
Sera Taei
Emily Ussher
Simmon Wilbore
Rebecca Williamson

Captain: Simmon Wilbore
Coach: Rebecca Greenhalgh
Manager: Mandy Souchon

HARDWOOD TECHNOLOGY COUNTIES MANUKAU

Eseta Autagavaia
Marcia Jerram
Destiny Katene
Hannah Kimber
Tori Kolose
Abbie Leger
Nadia Loveday
Khanyé-Lii Munro-Nonoa
Theresa Ngata
Maria Tatupu
Katie Te Ao
Jaelin Tulikaki

Captains: Tori Kolose and
Eseta Autagavaia
Coach: Michelle Parsons
Assistant Coach: Carron Jerram
Manager: Gemma Rowlinson
Primary Care: Sarah Fanuatunu
Apprentice Coach: Melissa Vanderkley

CHRISTCHURCH BLACK

Abigail Collier
Arlya Guard
Emily Hargreaves
Madeline Hassall
Samantha Laing
Kate Littlejohn
Aaliyah Metcalf
Holly Munro
Olivia Wilkie
Winnie Palamo
Georgia Reed

Captains: Kate Littlejohn and Georgia Reed
Coach: Andrea Cousins
Assistant Coach: Tyler Ngatai
Manager: Julia van Dyk
Primary Care: Wyllis Korent

DUNEDIN

Laura Axcell
Laura Balmer
Lose Fainga'anuku
Isabella Galvan
Poppy Kilworth
Ashlyn Koce
Rebecca Mace
Ella Mackenzie
Charlotte Nicol
Grace Southby
Meleitia Tatupu
Jess Tyrrell

Captains: Isabella Galvan and Poppy Kilworth
Coach: Janine Southby
Assistant Coach: Lauren Piebenga
Manager: Clare Malthus

CHRISTCHURCH WHERE

Raiha Campbell
Liv Clark
Taiana Day
Manaia Feather
Kate Grant
Charlotte Knight
Vika Koloto
Parris Petera
Ashleigh Poi
Louise Thayer
Julia Wynards

Captain: Parris Petera
Coach: Manaia Feather/Louise Thayer
Assistant Coach: Rachel Stead
Manager: Ronelle van Dongen
Primary Care: Katrina Keenan
Primary Care: Greg Knight

GISBORNE

Tania Adams
Marcia Beale
Ella Hurley
Grace Kaihe-Tahuri
Atareta Mangu
Karyn Matiaha
Bronya McMenamin
Paku-Jane Skudder
Princess Tomoana

Captain: Paku-Jane Skudder
Coach: Ingrid Brown
Assistant Coach: Charnelle Rutene
Manager: Challise Rutene

HAMILTON CITY

Jade Kawhe
Kaiya Kepa
Oceane Maihi
Holly Matson
Hylan Potts
Arikinoa Kay Shortland
Georgia Takarangi
Kate Taylor
Ali Wilshier

Captain: Georgia Takarangi
Coach: Rebecca Gabel
Manager: Daniel Short
Primary Care: Irene Gubb

HUTT VALLEY

Alofa Aberdein-Tapuai
Oakley Baldwin
Ayla Coupe
Tamara Howie
Maia Morehu
Kate Potts
Caity Prendergast
Jessie Robertson
Sina Tamaalii
Lucy Taylor
Sarah Whaanga
Trina Woodcock

Coach: Paul Randell
Assistant Coach: Jaimee Bialy
Manager: Elyse Herder
Primary Care: Jaimee Bialy

HOWICK PAKURANGA

Jordyn Brown
Jamie Clifford
Isabella Dunn
Hannah Dunn
Elenoa Gukirewa
Keely-Marie Samuel
Teuila Sotutu
Kayla Steele
Brooklyn Tharp
Lili Tokaduadua
Violet Toto
Katie Winchester

Coach: Tania Tuinukuafe
Manager: Shante Cameron
Assistant Manager: Stacey Kearns
Primary Care: Vania Dunn
Representative Convenor: Amanda Dyason

INVERCARGILL

Emily Allan
Rosie Brown
Hana Bryant
Kendall Corkery
Aliyah Dunn
Marina Ferguson
Bay-Leigh Johnson
Grace Namana
Siahn Nilsen
Billie Scurr
Te Huinga Reo Selby-Rickit
Della-May Vining

Coach: Te Huinga Reo Selby-Rickit
Assistant Coach: Lee Greig
Manager: Andrea de Vries
Primary Care: Corina Ngatuere

MANAWATU

Kara Adrole
Tyra Alexander
Jessica Fagan-Pease
Suraya Goss
Renee Matoe
Atareta McCausland-Durie
Sisavaii Muliaga
Lyric Paewai
Chantelle Smith
Sarah Teki-Clark
Madison Thomas
Layce Walker

Captain: Renee Matoe
Coach: Yvette McCausland-Durie
Assistant Coach: Katarina Cooper
Manager: Sharon Heaney
Primary Care: Sophie Manson

ROTORUA

Nicole Adams
Karlie Alexander
Leah Butterworth
Jessica Jackson
Stacey James
Jessica Lasenby
Erana Ngarimu
T'neya Onehi-Karena
Melissa Pinder
Allanah Raureti-Pari
Yasmin Richters
Kalley Tukaokao

Coach: Maylene Meroiti
Apprentice Coach: Danielle Ngatai
Manager: Veena Kameta

NORTH HARBOUR

Taylor Catchpole
Isarena Chan
Charli Foster
Grace Gaitau-Lui
Courtney Katterns
Ana Cagi Moi
Elizabeth Olney
Trinity Pakau
Aylessa-Jean Savelio
Auteletoa Tanimu
Rochelle Teiri

Coach: Julie Kelman-Poto & Ritua Aliivaa
Manager: Lyn Barr
Primary Care: Chris Johns
Primary Care: Joy Harrison

TARANAKI

Bree Clarke-Hutchieson
Mishka Katene-Rosa
Mechaela Major
Losalia Moeahu-Leota
Sarah Moller
Willow Rahui-Brown
Liahna Smith
Teesha Smith
Santana Tuhakaraina
Aliena Wallis

Captains: Teesha Smith and Mechaela Major
Coach: Che Tamati
Manager: Andrea Mulligan
Primary Care: Anna Winks

TAURANGA

Micaela Ashford
Amy Christopers
Reeghan de Bono
Billie Jo Hickton
Alex Iro
Kim Maisey
Ashley Maylor
Erena Mikaere
Chloe Murray
Amanda Redmond
Ivana Rowland
Jen Stilwell

Coach: Helena Houlst
Assistant Coach: Kyra Ormsby
Manager: Theresa Price
Primary Care: Morgana Grose

WELLINGTON

Rachael Albiston
Zalika Clarke
Mia Harries
Ellie Hurley-Langton
Torren Isaako
Mairangi Karaitiana
Crystal Lawrence
Grace McLean
Caitlin O'Sullivan
Jordyn Pfeiler
Jade Poi

Coach: Frances Solia
Assistant Coach: Maria Bertram
Manager: Margaret Perry

WAITAKERE

Dani Binks
Serina Daunakamakama
Areta Faifua
Genesis Heta
Paxton Maligi
Sila Matautia
Nadia Matthews
Jade McManus-Pennell
Sonya Ngau
Meadow Simpson
Summer van Gelder
Filda Vui

Captains: Paxton Maligi and
Filda Vui
Coach: Katherine Henry
Assistant Coach: Natalie Pati
Manager: Hedy Turner
Primary Care: Pat Hunt

- 1 The NetballSmart Netball New Zealand Open Champs will be conducted in accordance with the NNZ Competition Regulations with reference to the Policies and Procedures as contained in the Netball New Zealand Open Champs Event Guidelines and other Netball NZ Event Policies and Procedures.
- 2 Entries for the Netball New Zealand Open Champs shall be accepted from Netball Centres. Players must be female.
- 3 Players participating in the Netball New Zealand Open Champs must be members of Netball New Zealand and eligible for the Centre they are representing at the Championships in accordance with Netball NZ Membership & Registration Regulations.
- 4 Netball New Zealand reserves the right to accept entries from parties other than Netball Centres in New Zealand.
- 5 The Centre shall be responsible to ensure that all players selected for the Centre are eligible. Proof of date of birth (Birth Certificate, Passport) and/or eligibility may be requested by Netball NZ.
- 6 Players can only play in two of the three Netball New Zealand Domestic Events (Under 18 Champs, Open Champs and NZ Secondary School Champs) in a calendar year.
- 7 No more than three (3) ANZ Premiership players are eligible to compete for any one team at the Netball NZ Open Champs. For the 2023 Netball NZ Open Champs an ANZ Premiership Player is defined as a player who has been contracted on a standard playing agreement for the 2024 ANZ Premiership season.
- 8 Netball New Zealand shall circulate all team registration forms to each Zone/Centre no less than two weeks prior to the commencement of the championships. Any eligibility issues regarding players listed on these team lists must be raised one week prior to the commencement of the championships. For any players added subsequently eligibility issues must be raised following the distribution of updated team lists the night before the commencement of the championship.
- 9 Any team found to be in breach of the Netball NZ Membership & Registration Regulations will forfeit the game(s), in which that player(s) participated and will lose any corresponding championship points.
- 10 Where multiple teams are entered from one Centre the teams must be ranked with team 1 being the strongest, team 2 the second and team 3 the least etc.
- 11 Each team shall be under the control of a Coach and Manager or combination thereof.
- 12 Each team shall identify a Primary Care person on the team list – only this person will be permitted onto the court in the event of a stoppage to attend to on court player/s. Each team shall be issued with an armband prior to each game which the Primary Care person must wear in order to be permitted access to the court.
- 13 Each team must register a minimum of ten players and a maximum of twelve players on the Team Registration form.
- 14 All games shall be played in accordance with World Netball rules, unless otherwise stated in these rules and/or the Netball NZ Open Champs Event Policies and Procedures.

- 15 Games will consist of four (4) periods of twelve (12) minutes with intervals of four (4) minutes between the 1st & 2nd, and 3rd & 4th periods and an interval of six (6) minutes between the 2nd & 3rd periods.
- 16 Players on court may ask the Umpire for a stoppage without the reasons of injury/illness or blood being required. All other procedures around the stoppage are conducted as per current International Rules.
- 17 All games shall be played with netballs supplied by Netball NZ.
- 18 The umpires for all games shall be appointed by Netball New Zealand.
- 19 A team registration form and player profile forms shall be submitted to Netball New Zealand no later than the date as determined by Netball New Zealand, by each team entered.
- 20 The team registration form and individual player profile forms shall detail the full name, date of birth and playing position(s) of each player, and any other information requested by Netball New Zealand.
- 21 Each player listed shall endorse her consent to team registration by providing the information for the player profile form.
- 22 For the duration of the Netball NZ Open Champs, teams shall use only those players named on the final team list signed off on the evening prior to the commencement of the championship. If a player not named on this form plays in a game, the team concerned shall forfeit the game unless the replacement of a player on the registered team sheet has been approved by Netball New Zealand prior to the game concerned.
- 23 Once Netball NZ Open Champs play has commenced the list of registered players of any team may be altered only if, in the opinion of a medical practitioner, a player(s) is (are) deemed to be incapable of further participation in the Netball NZ Open Champs. In such a case, additional eligible player(s) may be registered provided that at no time the total number exceeds twelve (12).
- 24 Teams are able to replace an injured or ill player with a player from their Centre's lower ranked team at the event (see rule 23). This player will then become a member of this team and will no longer be eligible to play for their original team. Teams are not able to replace players with someone from a higher ranked team. The lower ranked team is then permitted to add a new player to their team to replace the one that moved up to the higher ranked team.
- 25 Evidence of a player's eligibility as a replacement registration may be requested by NNZ as detailed in rules 3 and 5.
- 26 Each team shall play in the registered uniform of the Centre.
- 27 All players shall be identified through names on their playing uniform or numbers on their uniform or body.
- 28 If alternative bibs are required for identification purposes the teams shall toss to decide who shall wear them.

- 29 No less than 30 minutes before a match commences, a team official must submit as directed by tournament officials a Team List. This will list all players taking the court, to commence the game, all substitute players and team officials. For games, that are televised, the team lists as above must be handed in at the time specified by Netball New Zealand prior to the scheduled start of the game.
- 30 Only those players and team officials named on the Team List may participate in that game and be in the team bench area. No other personnel are allowed to sit in or on the team bench area throughout the game. For the avoidance of doubt this includes spectators and parents.
- 31 No alterations or additions may be made to the team list within 30 minutes of the scheduled commencement time, except in the event of any injury/illness in the 30 minutes prior to the start of the game; a change in playing position(s) may be permitted if in the opinion of a medical practitioner the player is deemed to be incapable of commencing and/or participating in that game. In such a case, Netball NZ officials are to be notified immediately and subsequently the bench officials will be notified. For televised games the time period is in accordance with that specified by Netball New Zealand.
- 32 Teams are required to complete all games as specified in the draw format – failure to do so may result in the forfeiture of points or rankings.
- 33 Teams shall not be required to play more than two games on any day, except in the event:
- That a fair draw cannot be completed within the Netball NZ Open Champs; or
 - That a protest is upheld. The Netball NZ Open Champs Event Committee may then require an additional game to be played. Consideration shall be given to scheduling this game at a time, which allows appropriate recovery time for the teams concerned.
- 34 To avoid confusion team placement for each game will be allocated on the following basis:
- Team 1 on the draw will take the area to the RIGHT of the score bench as it faces out on to the playing court.
 - Team 2 on the draw will take the area to the LEFT of the score bench as it faces out on to the playing court.
- 35 During section or pool play points will be awarded as follows:
- | | |
|----------|---------------------------|
| 4 points | Win |
| 2 points | Draw |
| 1 point | Loss of 3 goals or less |
| 0 points | Loss by more than 3 goals |
- 36 In the event of a tie on points at the end of pool rounds, the result of the game between the two teams decides the winner. However;
- If the two teams drew their match, or if more than two teams have the same number of points at the end of the pool rounds, goal average of the pool games will decide the placing (i.e. goals for divided by goals against).
 - If goal average is identical, then goal difference will be applied (i.e. the difference between goals for and goals against).
 - In the event of a further tie, the team scoring the most goals will be declared the winner.

- 37 In the playoff and/or final rounds of the Championships, no draws are permitted. Such games shall be identified on the draw. In the event that the score is level at full-time, there will be;
- i. A one (1) minute interval at the end of full-time where substitutions and/or team changes can be made. All other stoppage provisions apply during the entire duration of Extra Time.
 - ii. Extra time of two (2) x three (3) minute halves each way will be played.
 - iii. Teams will have a one (1) minute interval between halves.
 - iv. Teams change ends and the game is restarted by the team entitled to the next centre pass.
 - v. At the end of the second period/half of extra time the end of play shall be indicated through audible signal and umpire alert. Play shall be held while the score is confirmed. If the two teams remain tied then play shall resume from the point where it was when the end of the second period/half was signalled, with the ball and possession commenced as it was when the second period of extra time ended. Play will continue until one team has a two (2) goal advantage.
 - vi. To indicate that the game has entered extended extra time as in (v) a visual signal will be placed on the score bench.
- 38 In the event of a dispute or incident report, any protests shall be made in writing to the Netball NZ Open Champs Event Committee within one (1) hour of the incident occurring or the completion of the game and prior to any official presentation, and accompanied by a fee of \$20.00. The fee shall be forfeited if the protest is considered to have been made without reasonable cause.
- 39 Upon receipt of a protest, or incident report the Netball NZ Open Champs Event Committee shall obtain the views of the other team and/or participants to the incident giving rise to the protest, or incident report and make such other enquiries, as it considers necessary. Before making a determination of the protest or incident report, it shall then inform the team protesting of the views of the other team/participants and any information it has obtained regarding the incident and give it an opportunity to respond to such views. Following this exchange of views, the Netball NZ Open Champs Event Committee shall consider the protest or incident report as soon as possible and make a determination. It shall advise the relevant teams and other parties of its decision regarding the protest or incident report as soon as possible.
- 40 The Netball NZ Open Champs is a Smokefree Netball Event. All participants and officials must refrain from smoking or vaping while at the Championship venue or at any Championship function.
- 41 No participant, team or official of the Netball NZ Open Champs shall be permitted to be sponsored by a tobacco or vaping product nor be permitted to advertise or sell a tobacco or vaping product while at the Netball NZ Open Champs consistent with the Smokefree Environments and Regulated Products Act 1990 and its amendments.
- 42 Sponsorship: The permitted size and positioning on apparel is detailed in the following document; Apparel Branding Rules & Guidelines 2023. Centres must abide by the rules in these documents and refer to Netball New Zealand for approval.
- 43 Individual player sponsorship is not permitted, unless otherwise agreed with Netball New Zealand in advance in writing.

- 44 Where under garment clothing or support items (for the avoidance of doubt an example of a support item is a calf sleeve) are worn by players on court, for reasons which may include but are not limited to; warmth, injury support and/or performance, then such items must be the same main colour as the players uniform/dress OR a neutral colour (black, white or beige). All items worn by any one player must be the same colour.
- 45 At all matches, those teams playing in the match may display one sign or banner, the placement of which will be determined by Netball NZ. The signs are to measure 2.4 metres by 0.6 metres landscape orientation. Signs must be freestanding while any banners must be attached for display as directed by NNZ. Signs or banners not meeting these specifications will not be permitted to be displayed. Such signs shall depict only the team sponsor's name and/or logo. No apparel manufacturer or other signage shall be permitted unless otherwise agreed with Netball New Zealand in advance in writing.
- 46 If any dispute arises from the interpretation of these rules or the need arises to deal with any matter not provided for in the rules, reference in writing shall be made to or by Netball New Zealand whose decision shall be binding on all parties.
- 47 Netball New Zealand has the right to amend or make additions to these rules as required and from time to time. Any rule updates will be circulated to all parties as required.

NETBALL NZ GENERAL CODE OF CONDUCT & ETHICS

As a Member of Netball NZ you must meet the following requirements in regard to your conduct during any activity held by or under the auspices of Netball NZ, a Zone or a Netball Centre and in any role you hold within Netball NZ, a Zone or a Netball Centre:

1. Respect the rights, dignity and worth of others.
2. Be fair, considerate and honest in all dealings with others.
3. Be professional in, and accept responsibility for your actions.
4. Make a commitment to providing quality service.
5. Demonstrate a high degree of individual responsibility especially when dealing with persons under 18 years of age.
6. Be aware of, and maintain an uncompromising adherence to Netball NZ standards, rules regulations and policies.
7. Operate within the rules of netball including national and international guidelines which govern Netball NZ, the Zone and Netball Centres
8. Understand your responsibility if you breach, or are aware of any breaches of this Code of Conduct & Ethics.
9. Do not use your involvement with Netball NZ, a Zone or Netball Centre to promote your own beliefs, behaviours or practices where these are inconsistent with those of Netball NZ, a Zone or a Netball Centre.
10. Wherever possible avoid unaccompanied and unobserved activities with persons under 18 years of age.
11. Refrain from any form of abuse towards others.
12. Refrain from any form of harassment towards, or discrimination of, others.
13. Provide a safe environment for the conduct of any netball or netball related activity.
14. Show concern and caution towards others who may be sick or injured.
15. Be a positive role model.

FOLLOW THE EVENT



netballnz.co.nz



facebook.com/NetballNewZealand



[@NetballNZ](https://twitter.com/NetballNZ)



[#WeLiveThisGame](https://twitter.com/NetballNZ)



instagram.com/NetballNewZealand



youtube.com/NetballNewZealand

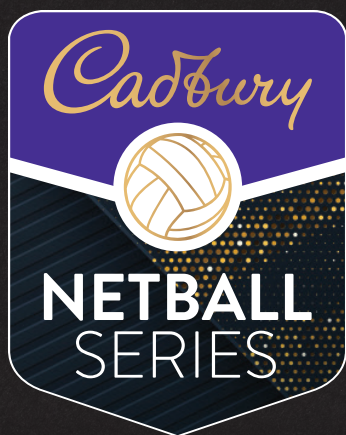

VS ENGLAND ROSES

25 September | 4pm
Wolfbrook Arena, Christchurch

27 September | 7.30pm
Te Rauparaha Arena, Porirua

30 September | 7pm
Globox Arena, Hamilton



TAINI
JAMISON
TROPHY

VS AUSTRALIAN DIAMONDS

19 October | 7.30pm
ILT Stadium Southland, Invercargill

23 October | 4pm
Spark Arena, Auckland



Tickets available from silverferns.co.nz

WATCH LIVE ON **sky**SPORT



6 TEAMS

15 WEEKS

45 GAMES

STARTS 13 APRIL 2024



TE WĀNANGA O RAU KAWA

